

# Sentry® QCIII Quick Connect Systems

*The cleanest, safest, most user-friendly connection system available for high-purity bulk chemical dispense*

Entegris introduced our first patented Quick Connect System over 25 years ago and our system remains the industry standard for high-purity chemical dispense. Expanding on the proven performance and functionality of this quick connect system, the Sentry® QCIII quick connect system is today's safest and easiest method of connecting chemical containers with typical bulk chemical delivery systems. This patented connection system comprises a key coded dispense head (DH3) and drum insert (DI3) that self align. Simply rotating the retaining ring pulls the DH3 and DI3 together so no visual line of site is required to make the connection – simplifying the assembly process significantly.

The Sentry QCIII quick connect system is designed for use with FluoroPure® chemical containers including HDPE transport drums, PFA composite drums, pressure vessels, and intermediate bulk containers.

## APPLICATIONS

- High-purity, corrosive chemical handling
- Ideal for high flow chemical distribution applications
- Bulk chemical delivery in pharmaceutical and biopharmaceutical applications



Sentry® QCIII Quick Connect Systems

## FEATURES & BENEFITS

The main chemical dispense line utilizes Flaretek® sealing technology	Provides a leak-free, secure connection without O-rings
	Eliminates the need for O-ring replacement and maintenance, minimizing downtime
Key coded system	Ensures against unsafe chemical mixing while guaranteeing dedicated clean service
Four ports are designed into the system	Enables recirculation and dispense operations in one connection, eliminating the need for an independent recirculation dispense head and drum insert
	Assembles faster, requires less labor, reduces maintenance, and lowers costs
Optimized dispense head flow path	Allows chemical dispense at 1.5x the flow rate of standard quick connection systems, reducing recirculation time and increasing process efficiency
Laser marked dispense head and drum insert	Allows quick visual identification and 100% traceability to a production date and production inspection record

## SPECIFICATIONS

<b>Materials of construction</b>	Dispense head:	Wetted parts include PFA, FEP, and Kalrez® 4001 materials. Wetted parts are Kalrez 6221 for Life Science applications.
		Nonwetted parts are PFA and polyethylene.
		Nut materials are PFA, PVDF or CPFA.
	Drum insert:	Wetted parts are PFA and/or polyethylene with FEP encapsulated o-rings. Nonwetted parts are polyethylene.
<b>Operating parameters</b>	Maximum pressure:	30 psig (207 kPa) @ 77°F (25°C)
	Maximum pressure on recirculation port:	5 psig (34.5 kPa)
	Regulatory:	All internal wetted surfaces are made from resins that comply with FDA regulation 21 CFR 177.1550 or 21 CFR 177.2600 for use as articles or components of articles intended to contact food. Representative samples of these resins have been tested for biocompatibility in accordance with USP protocol and all meet the requirements of a USP Class VI (121 C) plastic. These resins also do not use any animal derived materials as intentional components.

## PERFORMANCE DATA

Dispense Port Water Flow vs. Pressure Drop

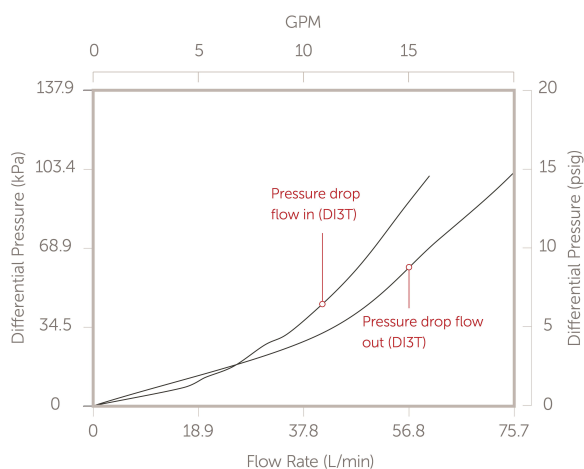

Dispense Port Water Flow vs. Pressure Drop

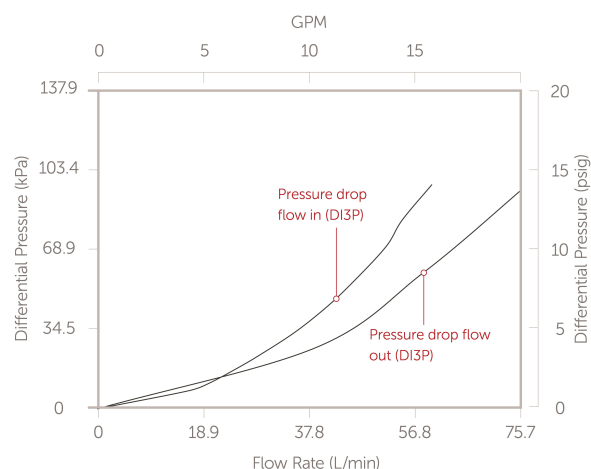

IntelliGen ULV Dispense Repeatability  
1.3 cP Fluid at 1.0 mL/sec Dispense Rate

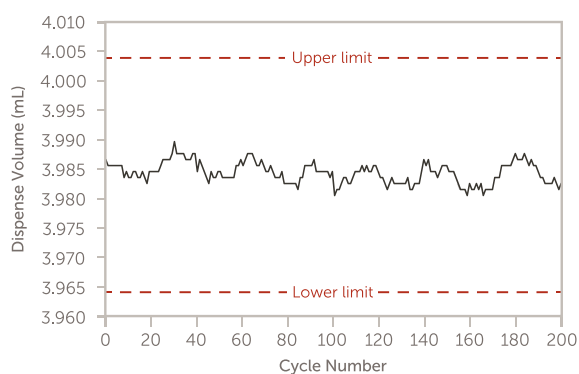

IntelliGen ULV Dispense Repeatability  
1.3 cP Fluid at 1.0 mL/sec Dispense Rate

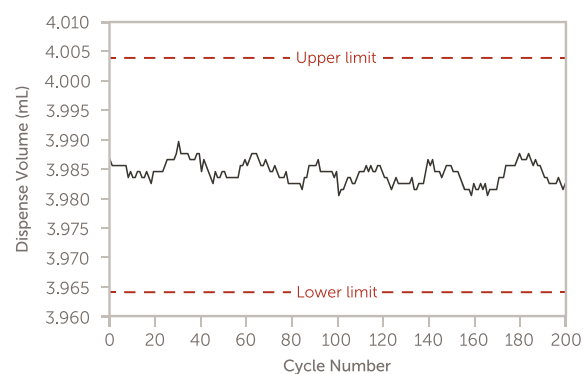

PERFORMANCE DATA

Dispense Port Water Flow vs. Pressure Drop

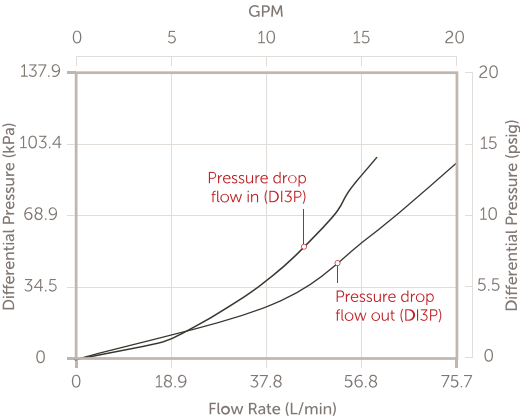

Dispense Port Water Flow vs. Pressure Drop

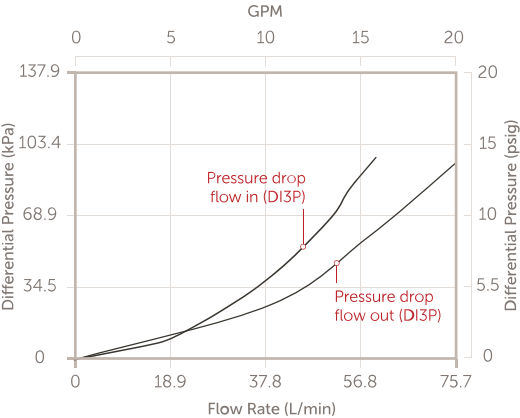

DRAWINGS

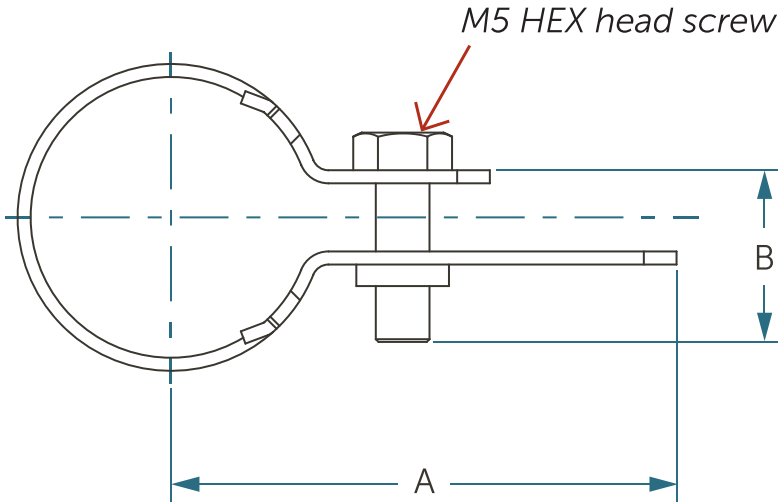
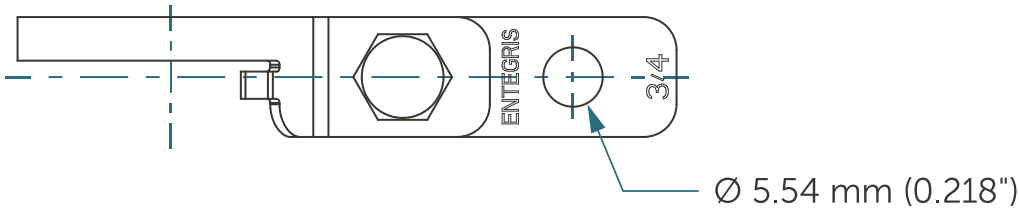

## Integra WS 2-way, Pneumatic Normally Closed Top View

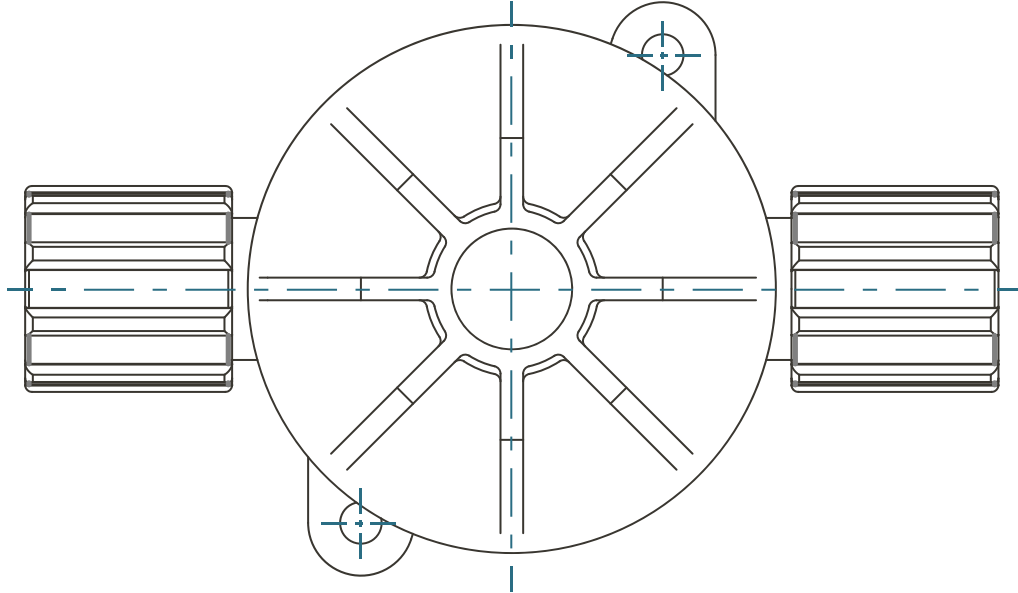

## Integra WS 2-way, Manual Multi-turn

Side View 1/4" and 3/8"

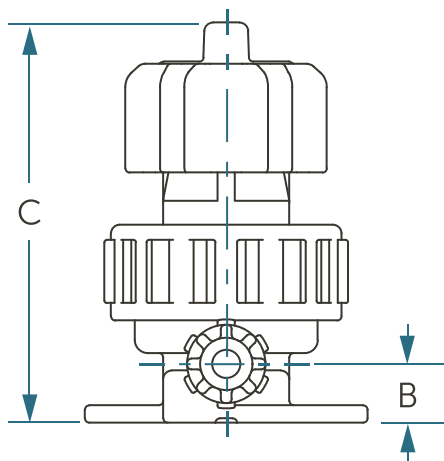

Side View 1/2" and 3/4"

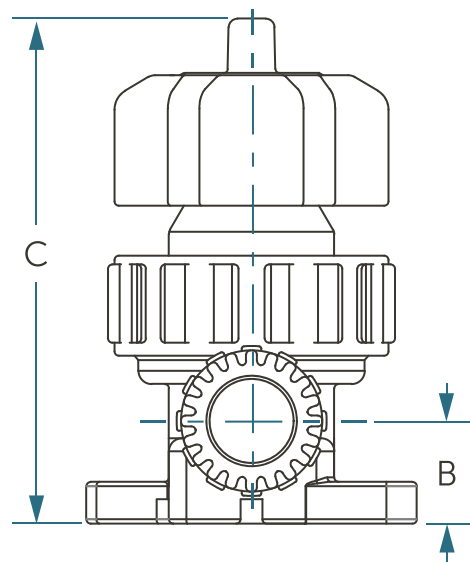

## DRAWINGS

Front View

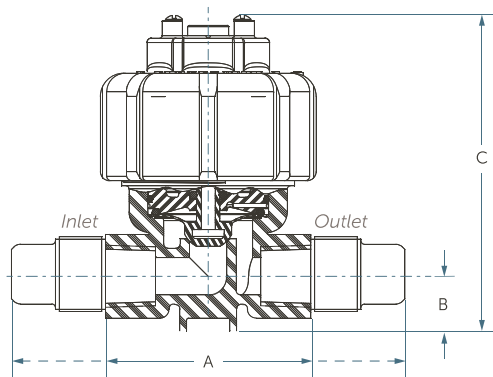

### FOR MORE INFORMATION

Please call your Regional Customer Service Center today to learn what Entegris can do for you. Visit [entegris.com](http://entegris.com) and select the [Contact Us](#) link to find the customer service center nearest you.

### TERMS AND CONDITIONS OF SALE

All purchases are subject to Entegris' Terms and Conditions of Sale. To view and print this information, visit [entegris.com](http://entegris.com) and select the [Terms & Conditions](#) link in the footer.



Corporate Headquarters  
129 Concord  
Billerica, MA 01821  
USA

Customer Service  
Tel +1 952 556 4181  
Fax +1 952 556 8022  
Toll Free 800 394 4083

Entegris®, the Entegris Rings Design®, and other product names are trademarks of Entegris, Inc. as listed on [entegris.com/trademarks](http://entegris.com/trademarks). All third-party product names, logos, and company names are trademarks or registered trademarks of their respective owners. Use of them does not imply any affiliation, sponsorship, or endorsement by the trademark owner.

Entegris, Inc. | All rights reserved. | Printed in the USA | 3560-2438ENT-1122

[www.entegris.com](http://www.entegris.com)